

Open type

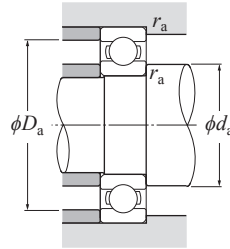

d 180–260 mm

d	Boundary dimensions			Basic load rating		Fatigue load limit C _u	Factor f ₀	Allowable speed		Bearing number
	D	B	r _{s min} ¹⁾	dynamic C _r	static C _{0r}			Grease lubrication	Oil lubrication	
180	225	22	1.1	67.0	73.0	3.40	16.1	2 600	3 000	6836
	250	33	2	122	119	5.45	16.5	2 400	2 900	6936
	280	31	2	129	134	5.85	16.5	2 300	2 700	16036
	280	46	2.1	210	199	9.70	15.6	2 300	2 700	6036
	320	52	4	252	241	11.9	15.1	1 900	2 200	6236
	380	75	4	390	405	19.0	13.9	1 700	2 000	6336
190	240	24	1.5	81.0	88.0	4.00	16.1	2 400	2 900	6838
	260	33	2	125	127	5.65	16.6	2 300	2 700	6938
	290	31	2	149	156	6.70	16.6	2 100	2 500	16038
	290	46	2.1	218	215	10.1	15.8	2 100	2 500	6038
	340	55	4	282	281	13.5	15.0	1 800	2 100	6238
	400	78	5	395	415	18.9	14.1	1 600	1 900	6338
200	250	24	1.5	82.0	91.5	4.05	16.1	2 300	2 700	6840
	280	38	2.1	174	168	7.45	16.2	2 200	2 600	6940
	310	34	2	157	160	6.65	16.6	2 000	2 400	16040
	310	51	2.1	241	243	11.2	15.6	2 000	2 400	6040
	360	58	4	298	310	14.4	15.2	1 700	2 000	6240
	420	80	5	455	500	22.3	13.8	1 500	1 800	6340
220	270	24	1.5	84.5	98.0	4.15	16.0	2 100	2 400	6844
	300	38	2.1	178	180	7.55	16.4	2 000	2 300	6944
	340	37	2.1	200	216	8.65	16.5	1 800	2 200	16044
	340	56	3	267	289	12.5	15.8	1 800	2 200	6044
	400	65	4	330	365	15.8	15.3	1 500	1 800	6244
	460	88	5	455	520	22.0	14.3	1 400	1 600	6344
240	300	28	2	94.0	112	4.55	15.9	1 900	2 200	6848
	320	38	2.1	188	203	8.05	16.5	1 800	2 100	6948
	360	37	2.1	197	217	8.30	16.5	1 700	2 000	16048
	360	56	3	276	310	12.8	16.0	1 700	2 000	6048
260	320	28	2	96.5	120	4.65	15.8	1 700	2 000	6852
	360	46	2.1	245	280	10.9	16.3	1 600	1 900	6952
	400	44	3	252	299	11.1	16.5	1 500	1 800	16052
	400	65	4	325	375	15.1	15.8	1 500	1 800	6052

1) Smallest allowable dimension for chamfer dimension r.

Dynamic equivalent radial load

$$P_r = X F_r + Y F_a$$

$\frac{f_0 \cdot F_a}{C_{0r}}$	e	$\frac{F_a}{F_r} \leq e$		$\frac{F_a}{F_r} > e$	
		X	Y	X	Y
0.172	0.19				2.30
0.345	0.22				1.99
0.689	0.26				1.71
1.03	0.28				1.55
1.38	0.30	1	0	0.56	1.45
2.07	0.34				1.31
3.45	0.38				1.15
5.17	0.42				1.04
6.89	0.44				1.00

Static equivalent radial load

$$P_{0r} = 0.6 F_r + 0.5 F_a$$

When $P_{0r} < F_r$ use $P_{0r} = F_r$.

Installation-related dimensions			Mass
d _a Min.	mm D _a Max.	r _{as} Max.	kg (approx.)
186.5	218.5	1	2.03
189	241	2	4.76
189	271	2	6.49
191	269	2	8.8
196	304	3	15.1
196	364	3	35.6
198	232	1.5	2.62
199	251	2	4.98
199	281	2	6.77
201	279	2	9.18
206	324	3	18.2
210	380	4	41
208	242	1.5	2.73
211	269	2	7.1
209	301	2	8.68
211	299	2	11.9
216	344	3	21.6
220	400	4	46.3
228	262	1.5	3
231	289	2	7.69
231	329	2	11.3
233	327	2.5	15.7
236	384	3	30.2
240	440	4	60.8
249	291	2	4.6
251	309	2	8.28
251	349	2	12.1
253	347	2.5	16.8
269	311	2	5
271	349	2	13.9
273	387	2.5	18.5
276	384	3	25